

TSFX-T

3-Piece, Teflon* Lined, Heavy Duty

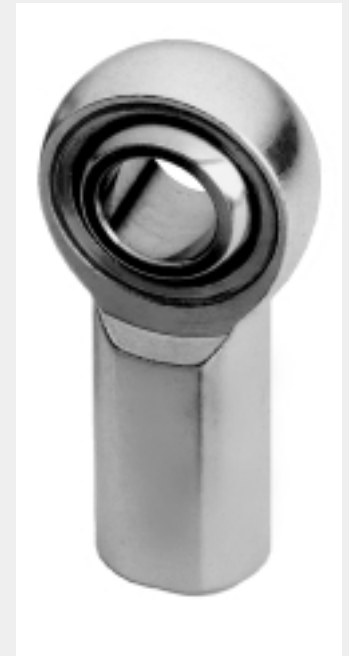
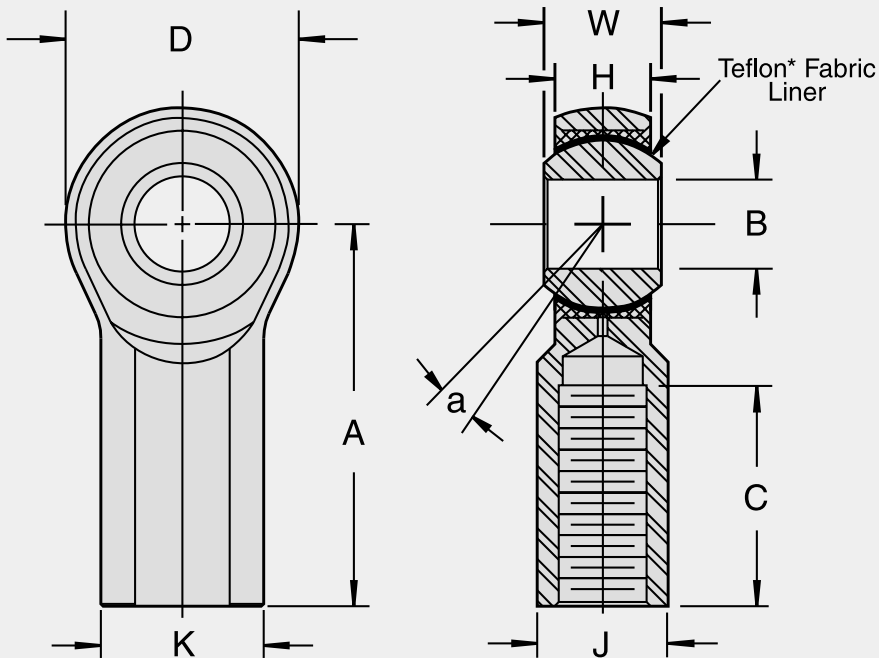

Part Number		B +0.0025 -0.0005	W +0.000 -0.005	H ±0.015	A ±0.015	D ±0.010	K ±0.010	J ±0.010	REF	C +0.062 -0.031	UNF-2B	a°	Ultimate Radial Static Load Capacity (Pounds)	Approx. Weight (Pounds)
Right Hand	Left Hand	Ball Bore	Ball Width	Housing Width	Centerline Length	Head Diameter	Shank Diameter	Wrench Flat	Ball Diameter	Thread Length	Thread Size	Misalign Angle		
TSFX3T	TSFXL3T	.1900	.312	.250	1.062	.625	.406	.312	.437	.500	10-32	13	3,733	.038
TSFX4T	TSFXL4T	.2500	.375	.281	1.312	.750	.469	.375	.500	.687	1/4-28	16	6,190	.059
TSFX5T	TSFXL5T	.3125	.437	.344	1.375	.875	.500	.437	.625	.687	5/16-24	14	7,639	.092
TSFX6T	TSFXL6T	.3750	.500	.406	1.625	1.000	.687	.562	.719	.812	3/8-24	12	9,544	.152
TSFX7T	TSFXL7T	.4375	.562	.437	1.812	1.125	.750	.625	.812	.937	7/16-20	14	10,285	.198
TSFX8T	TSFXL8T	.5000	.625	.500	2.125	1.312	.875	.750	.937	1.062	1/2-20	12	15,336	.329
TSFX10T	TSFXL10T	.6250	.750	.562	2.500	1.500	1.000	.875	1.125	1.375	5/8-18	16	17,955	.477
TSFX12T	TSFXL12T	.7500	.875	.687	2.875	1.750	1.125	1.000	1.312	1.562	3/4-16	14	28,081	.723

MATERIALS			
Ball	Body	Race	Liner
52100 Steel Rc 56 Min. Hard Chrome Plated	Alloy Steel Heat Treated Zinc Plated Clear Chromate Treated	Low Carbon Steel Zinc Plated Clear Chromate Treated	Teflon* Fabric Permanently Bonded to Race I.D.

NOTES:

1. This series is also available in a studed configuration. (Refer to chart in this catalog on page 66) Specify by adding "S" to suffix. Example: TSFX8TS

*A trademark of E.I. DuPont de Nemours & Co., Inc.